

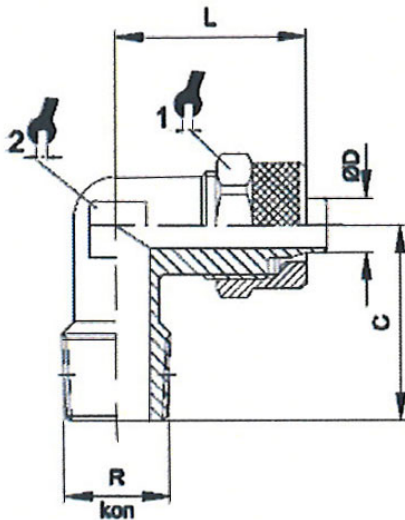

Material  
Max. operating pressure  
Suitable hose materials

Nickel-plated brass  
18 bar  
PA, PE, PU



13.114-8-E

### Male elbow, conical male thread (without O-ring)

| Art. No. | Type No.    | ØD    | A     | B    | C    | L    |  1 |  2 |
|----------|-------------|-------|-------|------|------|------|---|---|
| 115214   | 13.118-6-E  | 6/4   | R 1/8 | 8.0  | 17.0 | 22.5 | 12  | 8   |
| 115215   | 13.118-8-E  | 8/6   | R 1/8 | 8.0  | 17.0 | 22.5 | 14  | 10  |
| 115213   | 13.118-10-E | 10/8  | R 1/8 | 8.0  | 18.5 | 25.5 | 16  | 11  |
| 115211   | 13.114-6-E  | 6/4   | R 1/4 | 11.0 | 20.0 | 22.5 | 12  | 10  |
| 115212   | 13.114-8-E  | 8/6   | R 1/4 | 11.0 | 20.0 | 22.5 | 14  | 10  |
| 115210   | 13.114-10-E | 10/8  | R 1/4 | 11.0 | 21.5 | 25.5 | 16  | 11  |
| 115218   | 13.138-6-E  | 6/4   | R 3/8 | 11.5 | 22.5 | 23.5 | 12  | 11  |
| 115219   | 13.138-8-E  | 8/6   | R 3/8 | 11.5 | 22.5 | 24.0 | 14  | 11  |
| 115216   | 13.138-10-E | 10/8  | R 3/8 | 11.5 | 22.5 | 25.5 | 16  | 11  |
| 115217   | 13.138-12-E | 12/10 | R 3/8 | 11.5 | 24.5 | 30.0 | 18  | 14  |